

31 Lon Cwbr, Rhuddlan, LL18 2SX

£310,000

3 1 2



This detached three bedroom family property is in a impeccable condition, located in the popular historic village of Rhuddlan brimming with character boasting a medieval castle, a quaint row of shops, and a golf course, offering a blend of history and modern convenience. The residence features a versatile layout, offering a recently refurbished kitchen, offering a contemporary, stylish space for cooking with a utility room for convenience. In addition, the property possesses two reception rooms. One is currently designed as a dining room, providing a separate space to sit and enjoy meals together. En-suite facility to the master bedroom and fitted wardrobes to all bedrooms providing ample storage. Well maintained gardens with attached garage and off street parking. Overall, this property combines comfort and functionality in a charming village location. Its immaculate condition means it is move-in ready, making it an ideal home for families searching for their forever home.

- 3 Bedroomed Detached house
- Ideal Family Home
- Buss routes close by
- Tax Band E
- Freehold
- Desirable Area
- Local Schools
- Move into condition
- EPC - D
- Date: 07/05/2024

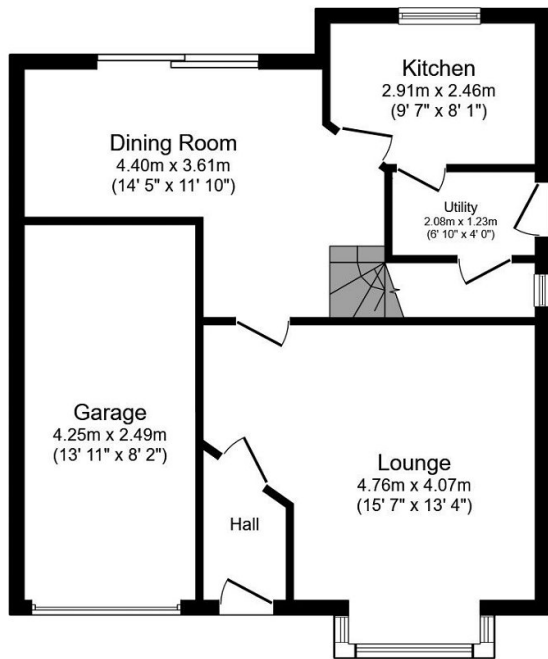

Ground Floor

Floor area 60.3 m² (649 sq.ft.)

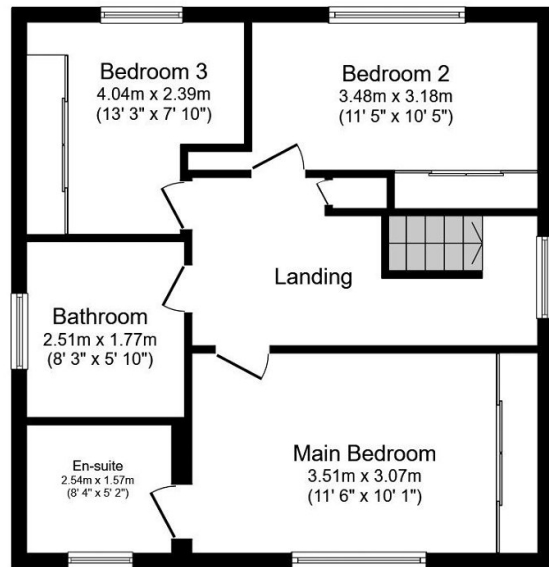

First Floor

Floor area 57.1 m² (614 sq.ft.)

TOTAL: 117.4 m² (1,264 sq.ft.)

This floor plan is for illustrative purposes only. It is not drawn to scale. Any measurements, floor areas (including any total floor area), openings and orientations are approximate. No details are guaranteed, they cannot be relied upon for any purpose and do not form any part of any agreement. No liability is taken for any error, omission or misstatement. A party must rely upon its own inspection(s). Powered by www.Propertybox.io